

# traulux

## INTERACTIVE MONITORS TX90 SERIES

TX6590 | TX7590 | TX8690



DISCOVER

*Simply Better...*

PHILOSOPHY

# INTERACTIVE MONITORS

## TX90 SERIES

*Simply Better...*



Available in **65", 75" and 86"** the **TX90** series represents Traulux's entry into the premium interactive sector with an unprecedented quality, price and service ratio.

It is built with the best components available on the market and assembled in one of the best factories in the world.

The user experience has been designed by **Traulux**, where being user-friendly has been one of the main objectives.



USB-C with 60 watt charge



Optional PC-OPS



Android 9.0 8Gb RAM 64Gb ROM



Freeze image



Mirroring 4K 9 projections

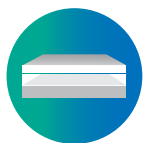

Optical Bonding Gen 1



20 writing points



Android 4K



3 zones whiteboard



Advanced trimming

# PREMIUM LCD-LED PANEL + BONDING TECHNOLOGY

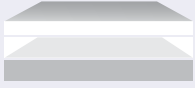

The **A-grade LCD panel** + the protective glass coupled with 1st generation **Bonding technology** provide first class image quality, viewing angle and direct writing feel on "Canvas".



## IR TECHNOLOGY WITH HIGH ACCURACY AND SPEED OF RESPONSE.

*On both Android and Windows.*



Experience extraordinarily natural writing thanks to its **"Hi END"** IR frame capable of maintaining writing speed and accuracy under any situation, even when using Windows INK tools.



 Windows INK Compatibility

## BOARD DIVISIBLE INTO UP TO THREE ZONES.

The working canvas can be divided into up to 3 totally independent areas, and in each of them choose a different color, or erase with the palm of the hand in one while writing in the other.

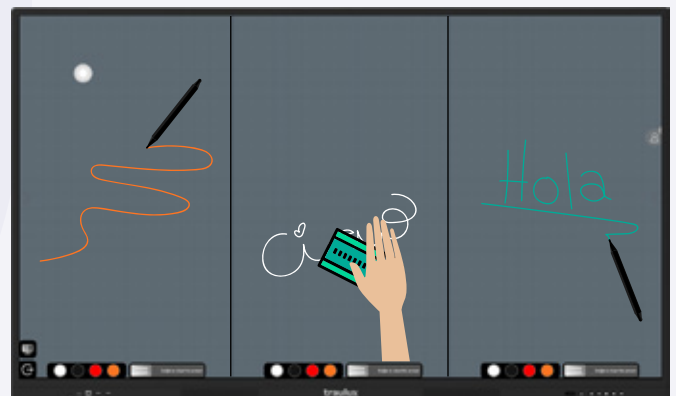

# EVERYTHING YOU NEED *IN JUST ONE CLICK*

## TX90 SERIES *Simply Better*



### 1.-FLOATING MENU

Direct access to the most used applications in any circumstance.

### 2.-INTEGRATED WIFI IN CHASSIS

With 2.4 Gb / 5 Gb selectable access point.

### 3.-SIDE MENU

Find tools and utilities easily, such as interactive voting or video capture.

### 4.- ANDROID AND 4K MIRRORING

Android interface and wireless projections in 4k, EsharePRO.

**Compatible projections with:**



### 5.- FRONT CONNECTIONS

1 x HDMI,  
1 x USB Touch  
2 x USB (3.0)  
1 x USB - C  
(Audio, video, touch, 60 watt)

### 6.-FRONT BUTTON PANEL AND LIGHT SENSOR

Quick access to the most frequently used functions. The light sensor allows the brightness to be adjusted automatically.

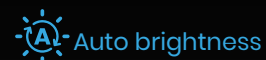

# DIRECT CONNECTION OF VC BARS AND MICROPHONES BY USB

Directly connect video conferencing bars or micro speakers to the USB-A or USB-C ports for video conferencing\* or to capture sound

when recording presentations with the built-in capturer.



\*Google Meet Web. No desktop sharing

## OPTIONAL MODULES

### CHROME OS

Add the versatility of **Google Workspace** to your monitor with the ASUS Chromebox 4 module. *\*View technical features.*

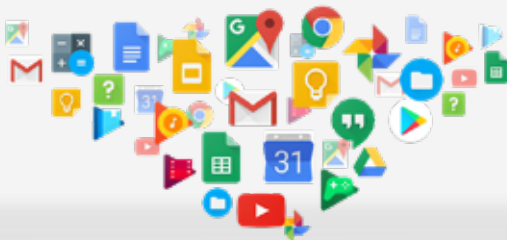

### PC-OPS

Add to the monitor the power of the **Windows O.S.** with one of the two available modules (i5 or i7). *\*See technical features.*



# TECHNICAL SPECIFICATIONS INTERACTIVE MONITORS

TX90 SERIES *Simply Better...*

**DISPLAY FEATURES**

Diagonal  
Visual technology  
Active area (mm)  
Aspect ratio  
Contrast (Typ.)  
Resolution  
Brightness  
Response Time  
Viewing angle  
Scheduled off time  
Auto off time programming  
Speakers  
Glass  
Bonding  
LED Panel Life  
Blue Light Filter

**TRAILUX TX6590**

65"  
LED  
1428.48 (H) x 803.52 (V)  
16:9  
1200:1  
4K Ultra HD (3840 \* 2160)  
400 cd/m2 (auto adjust)  
5 ms  
178°  
Yes  
Yes  
2 x 15 watt  
Anti-reflective / Anti-fingerprint  
1st Gen.  
50,000 Hours  
Yes

**TRAILUX TX7590**

75"  
LED  
1649.66(H) x 927.94(V)  
16:9  
1200:1  
4K Ultra HD (3840 \* 2160)  
400 cd/m2 (auto adjust)  
5 ms  
178°  
Yes  
Yes  
2 x 15 watt  
Anti-reflective / Anti-fingerprint  
1st Gen.  
50,000 Hours  
Yes

**TRAILUX TX8590**

86"  
LED  
1895.04(H) x 1065.96(V)  
16:9  
1200:1  
4K Ultra HD (3840 \* 2160)  
400 cd/m2 (auto adjust)  
5 ms  
178°  
Yes  
Yes  
2 x 15 watt  
Anti-reflective / Anti-fingerprint  
1st Gen.  
50,000 Hours  
Yes

**CONNECTIVITY**

HDMI Input  
HDMI Output  
DisplayPort Input  
USB-B (Touch)  
USB-A (2.0)  
USB-A (3.0)  
USB-C  
VGA + Audio  
RJ45 LAN  
RS232  
Headset Output  
Audio digital output  
Microphone Input  
Wi-Fi  
Bluetooth  
OPS Slot

3 (1 front, 2 side)  
1 (base - hasta 4K adjustable)  
1 (side)  
2 (1 front, 1 side)  
1 (side)  
4 (2 x front, 2 x side)  
1 (front, audio, video, 60 watts)  
1 (base)  
2 (side)  
1 (base)  
1 3.5 mm minijack (Dock)  
1 SPDIF Optical (Dock)  
1 (base)  
2.4 / 5GHz Integrated  
2.1+EDR/4.2/5.0  
1 (JAE 80 pin)

3 (1 front, 2 side)  
1 (base - hasta 4K adjustable)  
1 (side)  
2 (1 front, 1 side)  
1 (side)  
4 (2 x front, 2 x side)  
1 (front, audio, video, 60 watts)  
1 (base)  
2 (side)  
1 (base)  
1 3.5 mm minijack (Dock)  
1 SPDIF Optical (Dock)  
1 (base)  
2.4 / 5GHz Integrated  
2.1+EDR/4.2/5.0  
1 (JAE 80 pin)

3 (1 front, 2 side)  
1 (base - hasta 4K adjustable)  
1 (side)  
2 (1 front, 1 side)  
1 (side)  
4 (2 x front, 2 x side)  
1 (front, audio, video, 60 watts)  
1 (base)  
2 (side)  
1 (base)  
1 3.5 mm minijack (Dock)  
1 SPDIF Optical (Dock)  
1 (base)  
2.4 / 5GHz Integrated  
2.1+EDR/4.2/5.0  
1 (JAE 80 pin)

**INTERACTIVITY**

Technology  
Touch accuracy  
Response Time  
Touch points  
Writing tools  
Palm erase

IR - Double thickness  
1 mm  
5 ms  
40 touch points (20 writes)  
Pencil or finger  
Yes

IR - Double thickness  
1 mm  
5 ms  
40 touch points (20 writes)  
Pencil or finger  
Yes

IR - Double thickness  
1 mm  
5 ms  
40 touch points (20 writes)  
Pencil or finger  
Yes

**ANDROID**

Processor  
Memory  
Automatic updates (OTA)  
Interface resolution

Android 9.0, CPU: Quad-core Cortex A73 GPU: MaliG52 MP2

RAM 8G, Flash 64GB  
Yes  
4K

RAM 8G, Flash 64GB  
Yes  
4K

RAM 8G, Flash 64GB  
Yes  
4K

**APPS**

APK installation  
Freeze Image  
Floating Icon  
Split Mode (2 x apps simultaneously)  
Infinite whiteboard  
Resize objects in the frame  
Duplicate elements in the frame  
Android annotation layer  
Cutout android layer  
QR Generator  
Web Navigator  
Video Playback  
Videostreaming

Yes  
Yes  
Yes (configurable)  
Yes  
Yes (1, 2 or 3 independent zones)  
Annotations and images (vectorial)  
Yes  
Yes  
Yes (grid, free)  
yes (Cloud encrypted)  
Yes  
Real 4K  
Yes up to 4k (youtube)

Yes  
Yes  
Yes (configurable)  
Yes  
Yes (1, 2 or 3 independent zones)  
Annotations and images (vectorial)  
Yes  
Yes  
Yes (grid, free)  
yes (Cloud encrypted)  
Yes  
Real 4K  
Yes up to 4k (youtube)

Yes  
Yes  
Yes (configurable)  
Yes  
Yes (1, 2 or 3 independent zones)  
Annotations and images (vectorial)  
Yes  
Yes  
Yes (grid, free)  
yes (Cloud encrypted)  
Yes  
Real 4K  
Yes up to 4k (youtube)

**MIRRORING**

EsharePRO 4K: 9 simultaneous projections, compatible in its own Hot Spot (2.4 Gb / 5 gb) with outgoing internet transmission (LAN) to devices. Android, iOS (Airplay direct), Chrome, Ubuntu Windows (2 Touch) and MAC O.S (2 touch)

**INCLUDED ACCESSORIES**

Wall bracket  
Pencil dubbing tip  
Remote control  
USB-C cable (Thunderbolt 3)  
Power cable  
HDMI cable  
USB A-B cable

Yes  
2  
1  
1  
1 x 3 m  
1 x 3 m  
1 x 3 m

Yes  
2  
1  
1  
1 x 3 m  
1 x 3 m  
1 x 3 m

Yes  
2  
1  
1  
1 x 3 m  
1 x 3 m  
1 x 3 m

**SIZE / WEIGHT**

VESA  
Net Weight (kg ±2)  
Dimensions (W. x D. x H.)

600 x 400  
47  
1511,6 x 87,8 x 920,3 mm

800 x 400  
65  
1722,5 x 87,1 x 1034,6 mm

800 x 600  
95  
1.967 x 87,1 x 1172,6 mm

**POWER**

Voltage  
Consumption

100 -240V AC  
Max. 300W-at stand-by <0.5W

100 -240V AC  
Máx. 380W-at stand-by <0.5W

100 -240V AC  
Máx. 460W-at stand-by <0.5W

**WARRANTY**

5 years In Situ with reinstallation (Spain / Portugal)

5 years In Situ with reinstallation (Spain / Portugal)

5 years In Situ with reinstallation (Spain / Portugal)



# TECHNICAL DRAWINGS

## INTERACTIVE MONITORS

### TX90 - TX6590 SERIES

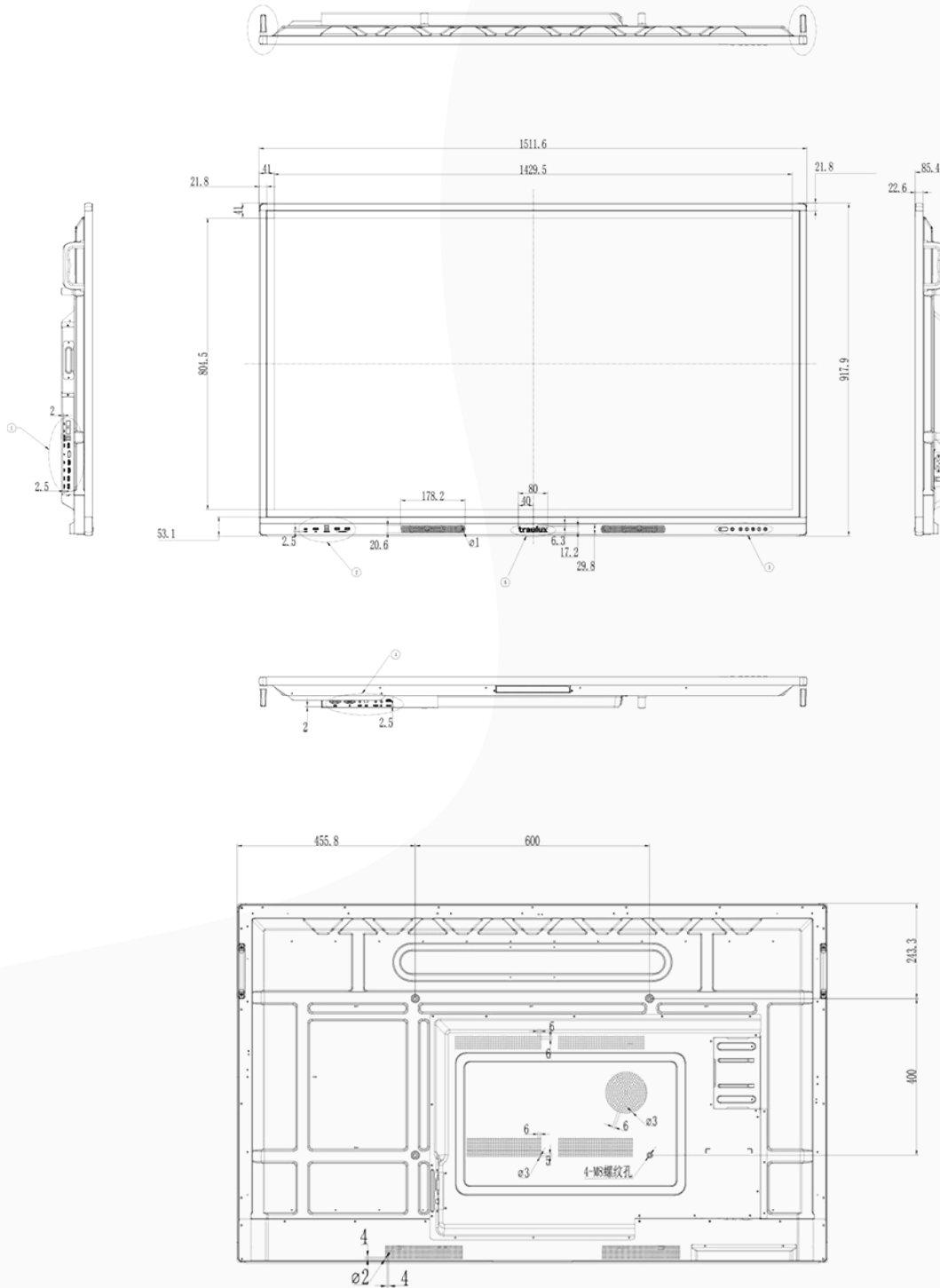

# TECHNICAL DRAWINGS

## INTERACTIVE MONITORS

### TX90 - TX7590 SERIES

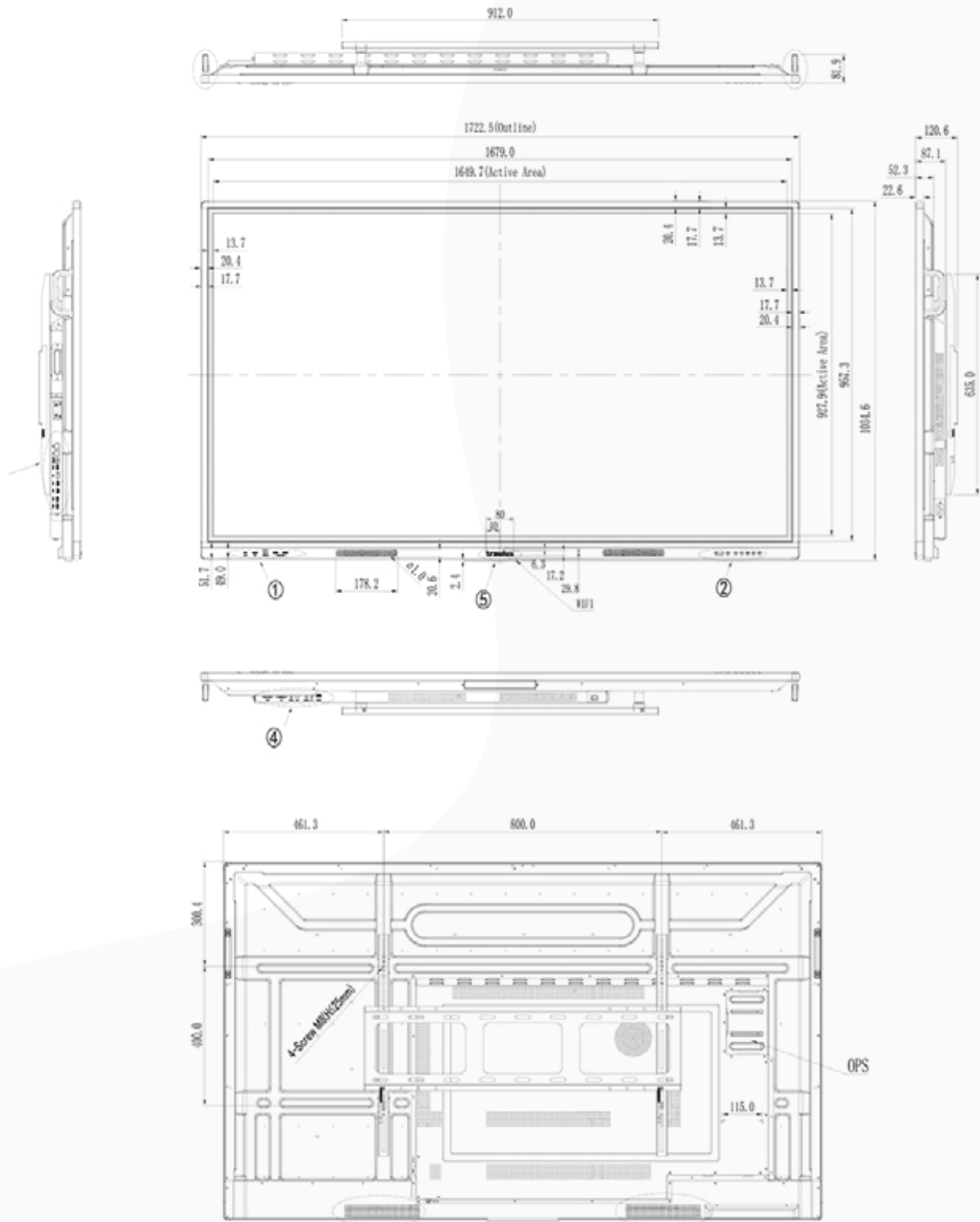

# TECHNICAL DRAWINGS

## INTERACTIVE MONITORS

### TX90 - TX8690 SERIES

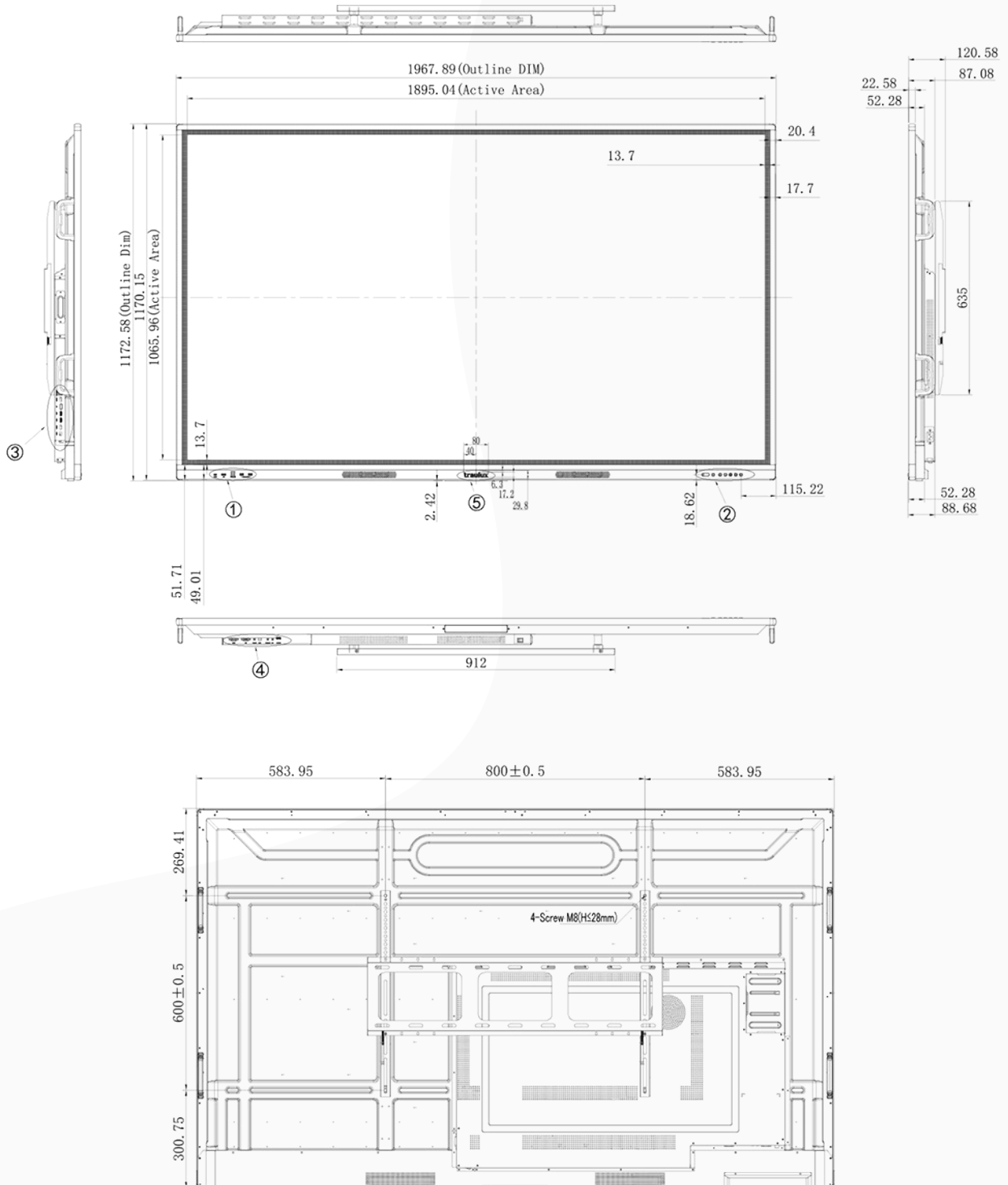

# traulux

## INTERACTIVE MONITORS

### TX90 SERIES

TX6590 | TX7590 | TX8690



## DISCOVER

*Simply Better...*

## PHILOSOPHY

CATALOGUE 2022 - 2023

[charmex.net](http://charmex.net) | [traulux.net](http://traulux.net)